

Science Facilities Comprehensive Plan

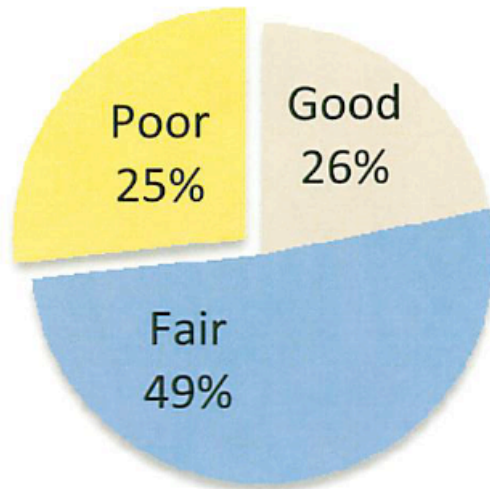

- 1,178K NSF existing
- 25 % of Science/Engineering buildings are older buildings in poor condition
- 297K NSF of poor space
- 574 K NSF of fair space
- 307 K NSF of good space

Bridge Strategy

- Maximize expenditure for greatest return.
- Minimize expenditure on lowest return.

% Poor space

Meeting with the EOC 24 Feb 2009



Comprehensive Science Plan Overview

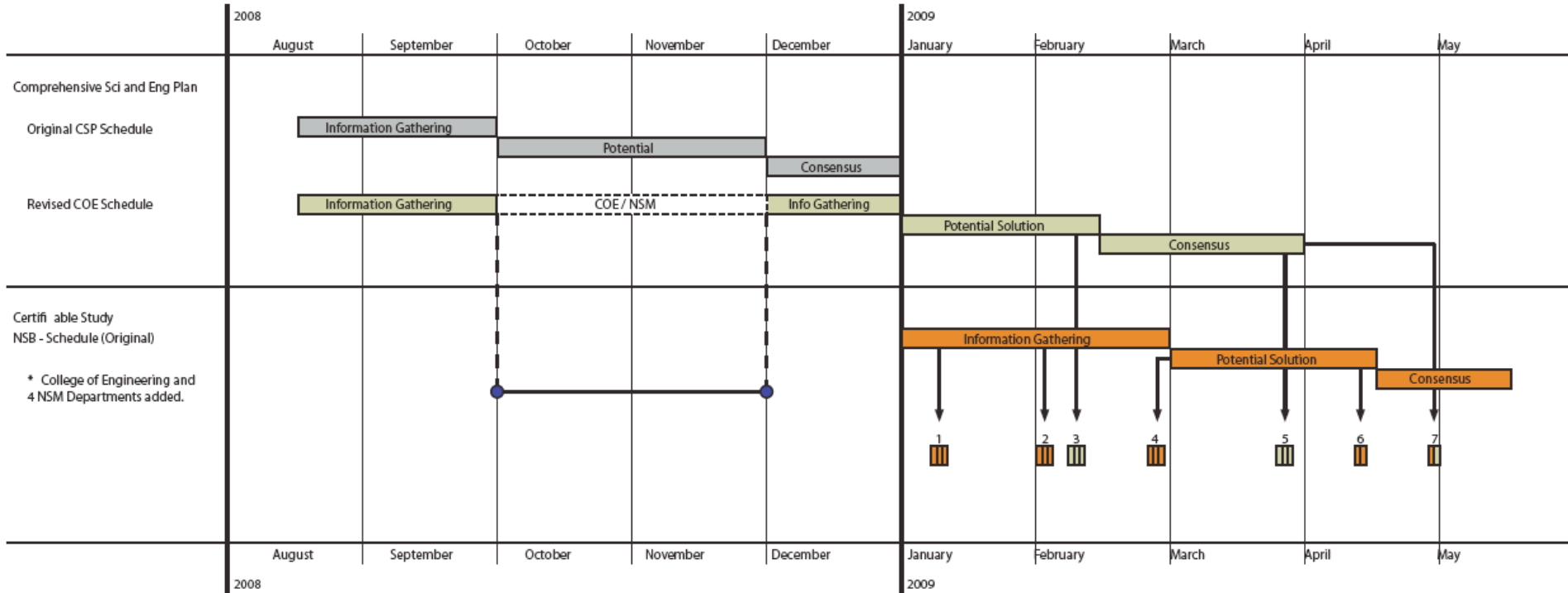

In Track One, the project goal is develop a plan for meeting science and engineering needs in the long term by implementing a combination of renovation and new construction projects in phases over five, ten, and more than eleven years. The primary objective of Track two is to determine the program and conceptual plan for the New science Building. An important part of the planning for the building has been the decision not to determine specific building occupants at the outset, but to allow time for an executive committee reporting to the Chancellor to commence work on the selection process that will commence this spring.

Backfill - Where will 'bridge' funds go?



Morrill \$3-4M

- For 5 years
- Animal Care in Morrill I



Goessmann \$10.6M

- Recruiting space
(20K NSF vacant, 7-8 new hires)
- Relocated space



Paige \$5-6M

- Vacating Stockbridge basement
(11 K NSF to 18 K NSF in Paige)
- Consolidating PSIS

Proposed LGRT renovations

LGRC TOWER - LEVEL 8

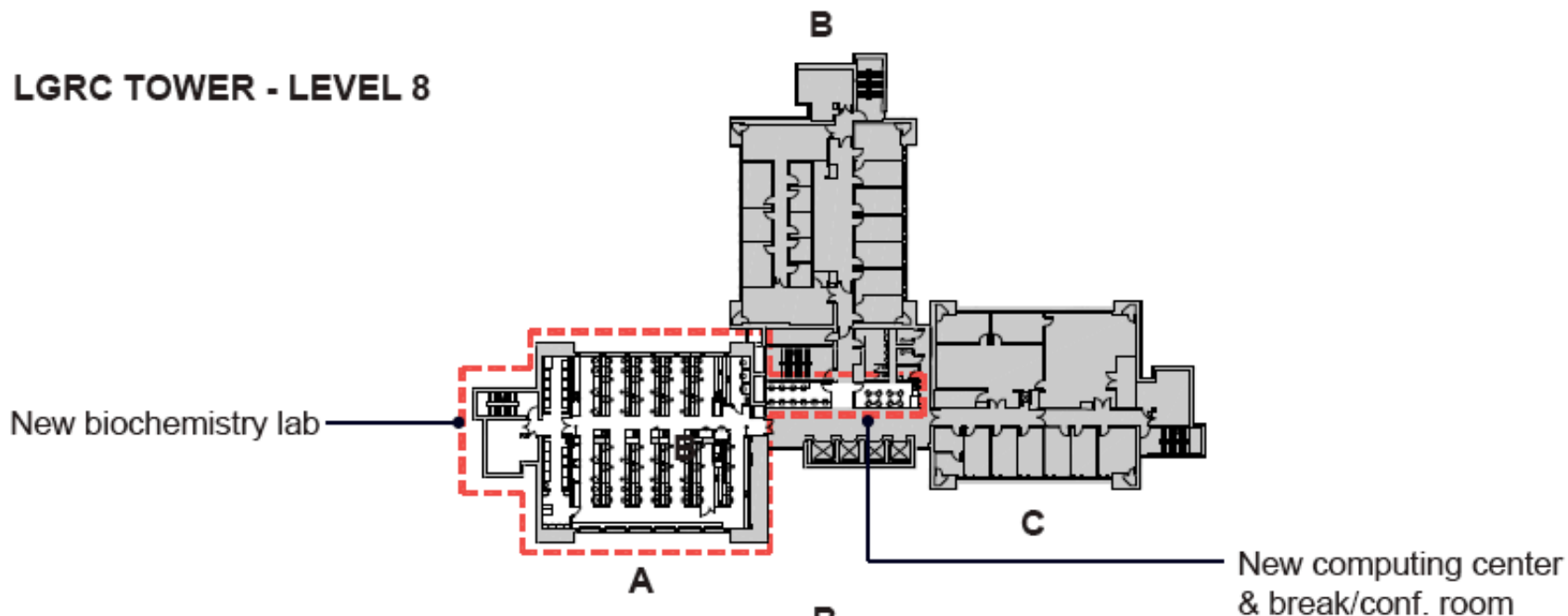

LGRC TOWER - LEVEL 7

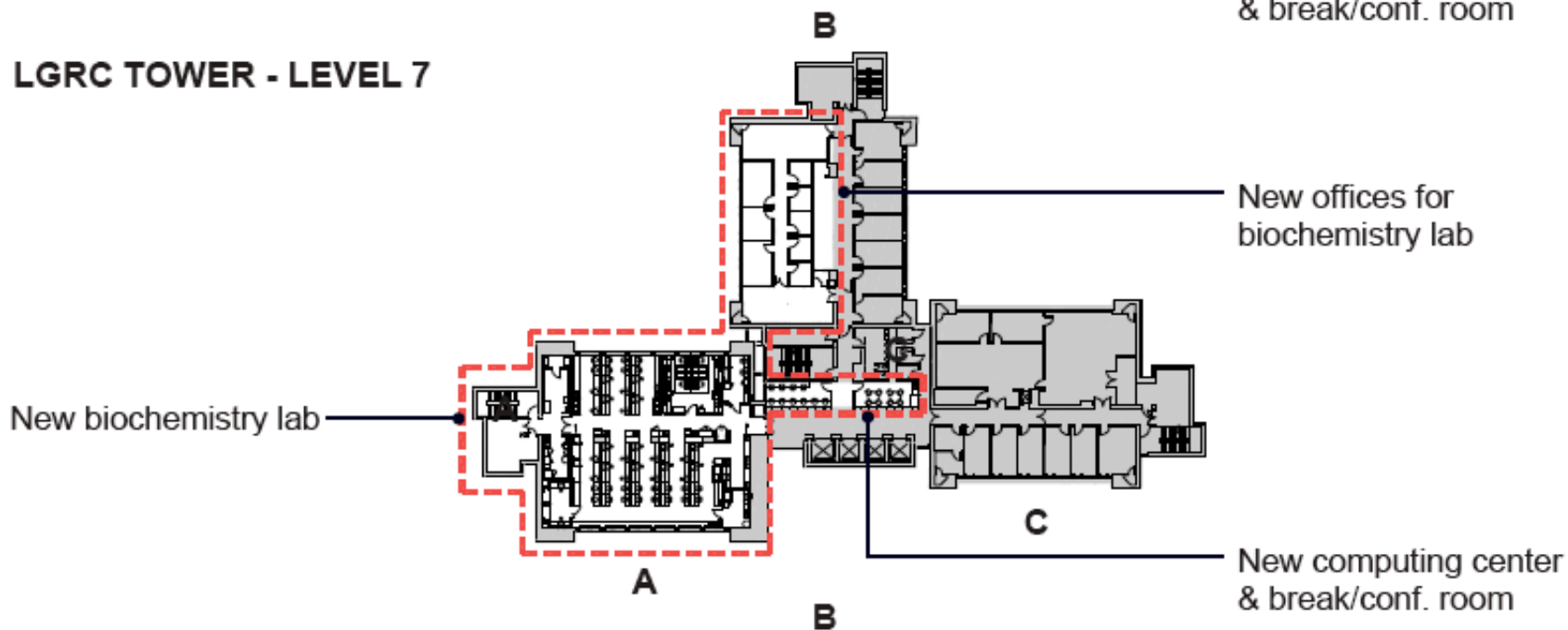



-  New Construction
-  Renovation
-  Re-purposed
-  Remove from inventory

axonometric - short term

umass executive committee